

ISO A1 594mm x 841mm



Image 1 | Culvert W1 Looking North



Image 2 | Typical Directional Drilling Rig



Image 3 | Typical Launch Pit

Map Series:  
Prime Data Vector

ITM Centre Point Co-ordinate:  
X,Y = 604428.4395, 703117.9702

Tailte Éireann Licence No.  
CYAL50261649

Copyright:  
© Tailte Éireann, 2024



Head Office  
Beenreigh,  
Abbeydorney,  
Tralee, Co. Kerry  
Ireland  
Tel: 00353 66 7135710

Regional Office  
Basepoint Business Centre  
Scroudlery Road, Basingstoke,  
Hampshire,  
RG24 8UP, UK  
Tel: 00 44 1256406664

PROJECT

**Ballincor Wind Farm  
110kV Grid Connection**

CLIENT

**RWE**

CONSULTANTS

**TOBIN**  
Consulting Engineers

NOTES: -

- This drawing is to be used only for the purpose of the planning application and is subject to detailed design.
- A Specialist HDD Contractor To Confirm The Bore Size And Trajectory of the Drill Shots Following Detailed Ground Investigation Works.
- Other services may be encountered on the route.
- Position and size of the HDD launch/reception areas shown are indicative only and will be subject to site investigation works and detailed design.

LEGEND: -

- Proposes 110kV UGC Route
- Planning Application Boundary
- HDD Crossing Location
- Temporary Compound Drilling (HDD) Area

ISSUE/REVISION

NO	DATE	DESCRIPTION
P2	07.07.2025	Issued for Planning
P1	26.11.2024	Issued for Planning
I/R	DATE	DESCRIPTION

PROJECT NUMBER  
**05-867**

SHEET TITLE  
**Horizontal Directional Drilling (HDD)  
Culvert W1**

SHEET NUMBER  
**05867-DR-215**

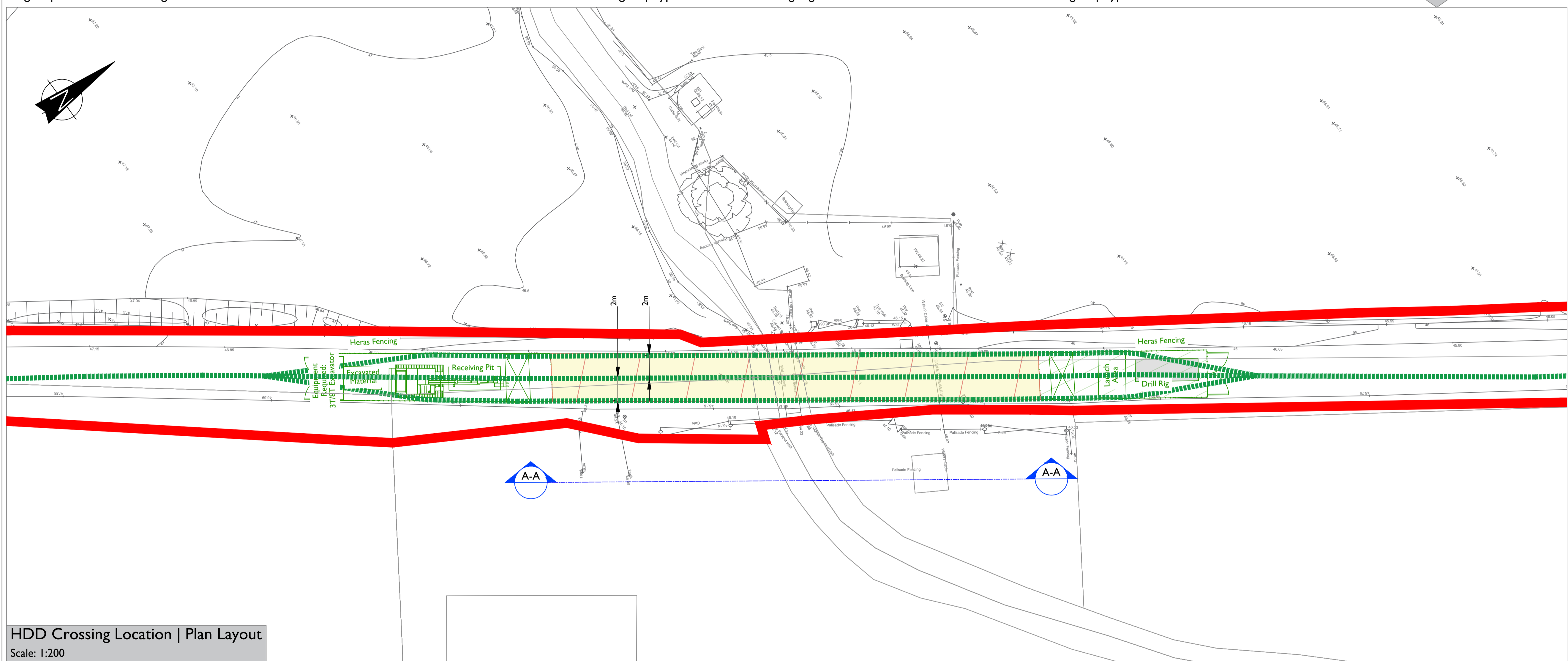

HDD Crossing Location | Plan Layout  
Scale: 1:200

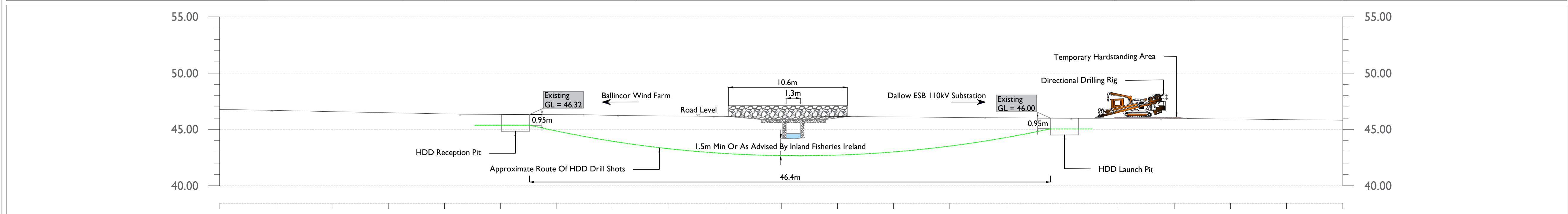

Section A-A | Directional Drilling Under Culvert W1  
Scale: 1:200

Project Management Initials: Designer: AR Checked: NOC Approved: GH